

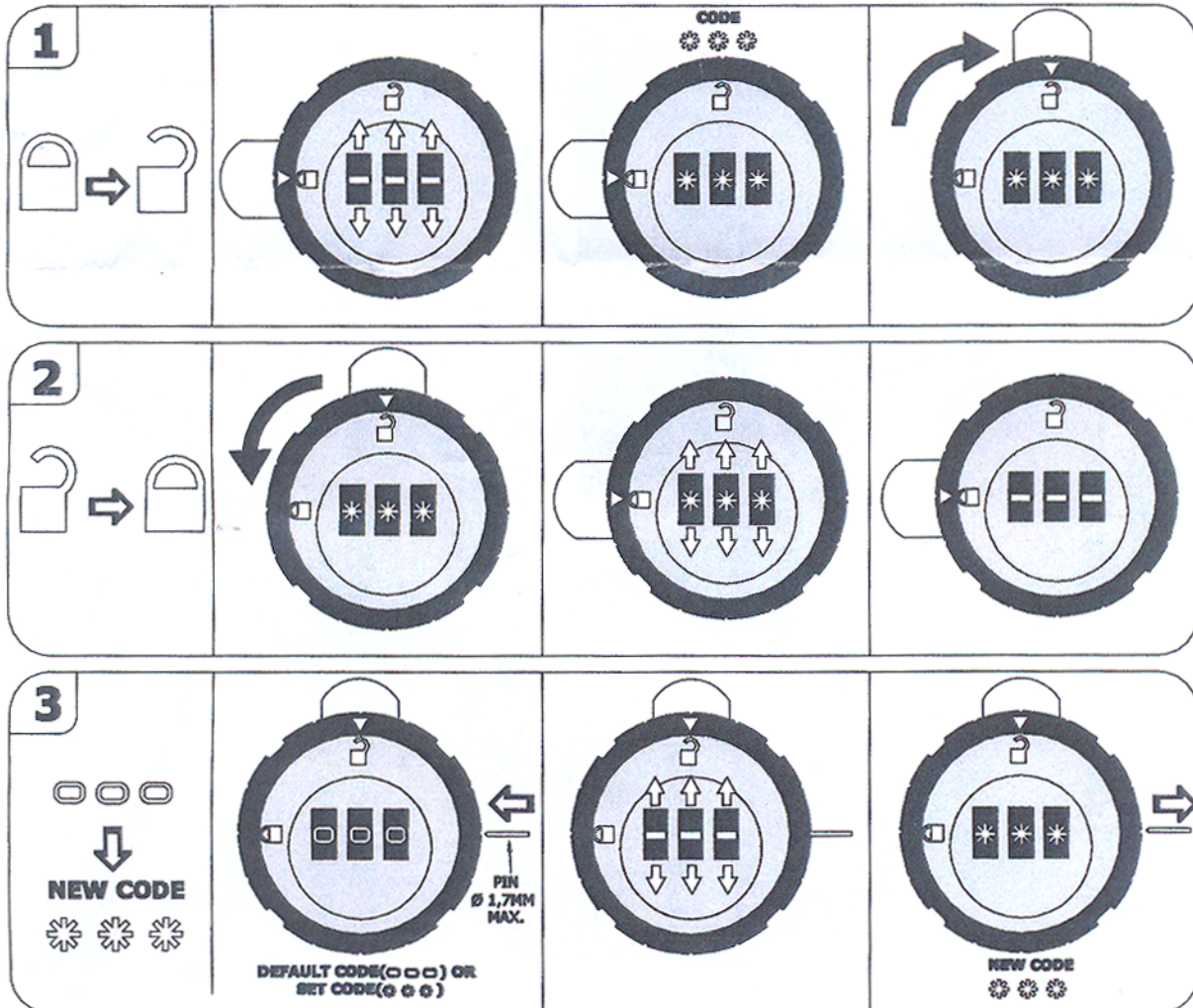

OPERATING INSTRUCTIONS COMBINATION LOCK A138



- ON DELIVERY, LOCK IS FACTORY SET TO THE DEFAULT CODE 0 0 0. FOR SAFETY REASONS SET LOCK IMMEDIATELY TO YOUR OWN PERSONAL CODE (SEE POINT 3 BELOW).
- TO SET THE CODE USE A SOLID PIN WITH AN DIAMETER OF MAX. Ø 1,7MM. DO NOT USE A WOOD PIN!
- DO NOT LUBRICATE THE CODE WHEELS.
- MAKE SURE THAT CAM MOVES FREELY WHILE OPERATING THE LOCK.
- LOCK OPERABLE WITHIN A TEMPERATURE RANGE OF 0° TO 50°C (32°F TO 120°F)
- DO NOT EXPOSE LOCK TO ENVIRONMENTAL INFLUENCES (MOISTURE, FIRE, DUST, ETC)
- CLEAN LOCK WITH A DAMP CLOTH. DO NOT USE CHEMICAL PRODUCTS!
- DO NOT INSERT FOREIGN OBJECTS IN THE CODE WHEELS.
- CAM IS FIXED BY SELF-TAPPING SCREW. TORQUE TO TIGHTEN SCREW MAX.2Nm
- MAXIMUM PANEL THICKNESS 12MM



EURO-LOCKS SICHERHEITSEINRICHTUNGEN GMBH
 AM BRUCHWALD 22, D-66280 SULZBACH/NEUWEILER
 TEL: +49-(0)6897-9072-0 FAX: +49-(0)6897-9072-99
 WEB: WWW.EURO-LOCKS.EU MAIL: VERTRIEB@EURO-LOCKS.DE



EURO-LOCKS Sicherheitseinrichtungen GmbH

3-Wheel Combination lock A138

Procedure to open the combination lock in case of code loss

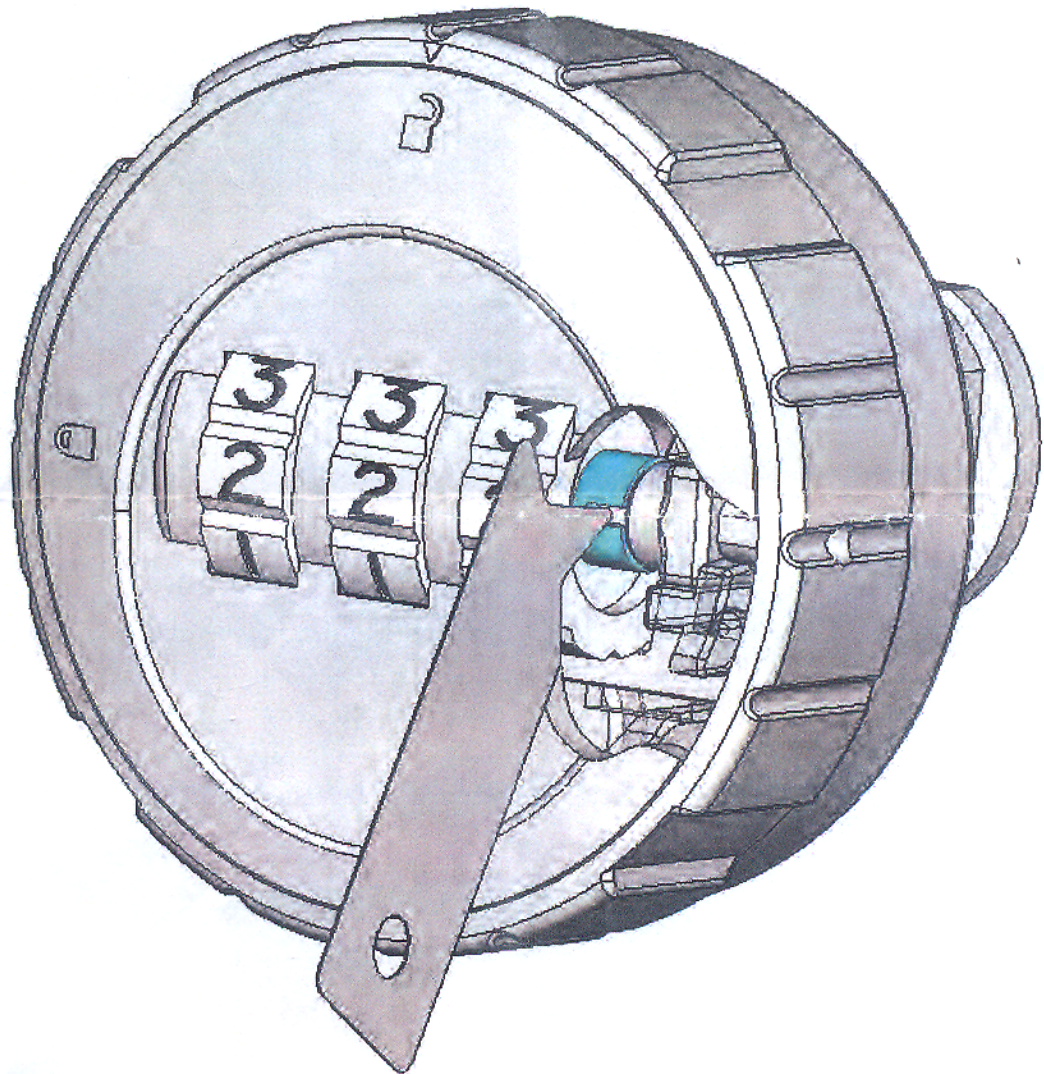

1. Insert the feeler blade into the gap to the right of each code wheel.
2. Turn the code wheel slowly and move the point of the feeler blade over the radius of the axis until the recess is found.
3. Deduct two from the number shown on each wheel to find the correct code: Code found 2 2 2 - correct code 0 0 0